



# SEAGA

Southeast Asian Geography Association

NIE-SEAGA Conference 2006  
28 to 30 Nov 2006  
@ Nanyang Girls High School, Singapore

Jointly Organised by



Co-hosted by



Partners and Sponsors:

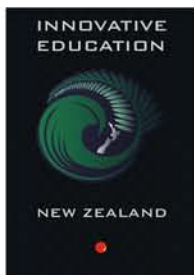

# Programme & Abstracts

## NIE-SEAGA Conference 2006



# Sustainability and Southeast Asia

28 - 30 Nov 2006

@ Nanyang Girls High School, Singapore

2 Linden Drive  
Singapore 288683

# Contents

Contents.....	1
General Information.....	1
Message.....	2
Programme for Day 1 .....	2
Programme for Day 2.....	5
Programme for Day 3.....	8

# General Information

Map of main venue

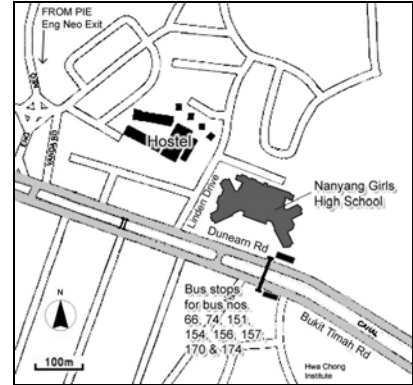

2, Linden Drive, Singapore 288683

# Organising Committee

Chairperson	Prof Ooi Giok Ling
Secretary	As/P Chang Chew Hung
Treasurer	A/P Kalyani Chatterjea
	As/P Ivy Tan
Programme	A/P Wong Tai Chee
	A/P Elisabeth Bui
	Dr. Philip Tieh
Logistics	Ms Lian Lay Cheng
Publicity	Ms Esther Cheong
Fieldtrips	As/P Yan Liu
Schools Rep	Mdm Ang Siew Hong
Advisor	Prof Goh Kim Chuan

# Venue for sessions

## Room layout for Level 1

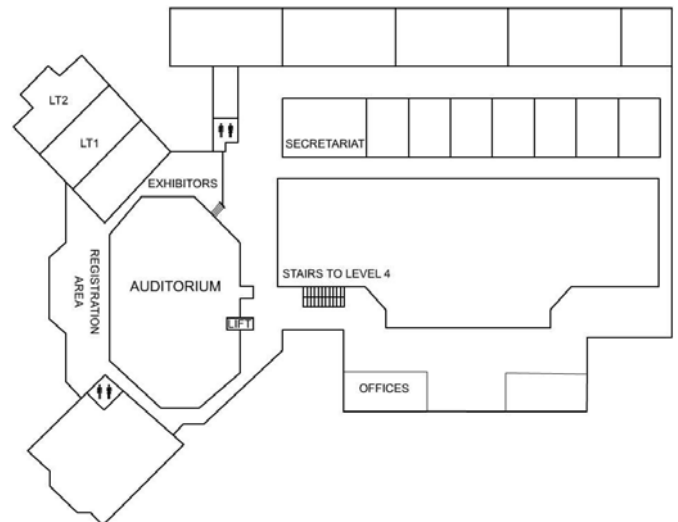

## Room layout for Level 4

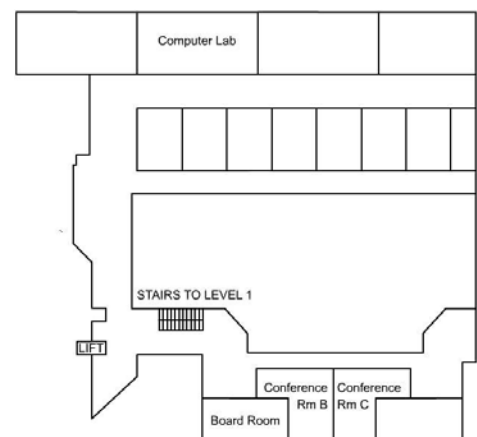

## Message

SEAGA, the Southeast Asian Geography Association, celebrates its 16th year as an association of geographers and professionals in related fields like history, the geo and environmental sciences, urban planning and others in academia, education, government and the private sector in the region, in 2006. The SEAGA Conference 2006 is also the 8th conference that is being organised since the association was established in 1990.

SEAGA is inviting trans-disciplinary perspectives of sustainability from scholars, policy makers and entrepreneurs as well as researchers and teachers. The aim is to debate the progress which the Southeast Asian region has made towards sustainability. Such assessment concerns national governments, local processes in cities and the agricultural areas as well as the business sector. This debate should translate the concept of sustainability into terms relevant for all who have worked to advance the cause. Sustainability is however, a contested concept and there is an urgent need to provide the terms upon which citizens and governments alike, consumers and producers can engage effectively with processes of realising the goals that have been set.

Sustainability and Southeast Asia is the conference theme in 2006 and we have 11 keynote and plenary addresses, 14 specialist panel session comprising 52 papers and 78 open session papers presenting multidimensional perspectives of sustainability from scholars, policy makers and entrepreneurs as well as researchers and teachers. There are in all 141 papers and presentations over three days of the conference which will be attended by more than 300 academics, social activists, teachers and students from over 23 countries in Asia and beyond. We are looking forward as an association and researches alike, to working with colleagues across the region and elsewhere on development issues that are of relevance to the Southeast Asian region. Welcome to the conference and the networks based on research and debate that SEAGA looks forward to building with you.

Professor Ooi Giok Ling  
President  
Southeast Asian Geography Association

## Programme for Day 1

28 November 2006

0800 - 0845	<b>Registration</b>
0845 - 0900	All Delegates and Guests To Be Seated
0900 - 1000	<p>Welcome Address: <b>Prof. Ooi Giok Ling</b>, President, SEAGA</p> <p>Opening Address: <b>Assoc. Prof. Ho Peng Kee</b>, Senior Minister of State for Home Affairs and Law</p> <p>Keynote Address: <b>Prof. Mark Cleary</b> Deputy Vice-Chancellor, University of Plymouth</p> <p>Session Chair: <b>Prof. Goh Kim Chuan</b>. Venue: <b>Auditorium</b></p>
1000 – 1100	<b>SIIA Forum Brunch</b>
1100 - 1230	<p><b>SIIA Plenary</b></p> <p>Speakers:</p> <p><b>Mr Rae Kwon Chung</b> Director, Environment and Sustainable Development Division</p> <p><b>Dr Mubariq Ahmad</b> Executive Director, WWF-Indonesia</p> <p><b>Mr Masanori Kobayashi</b> Senior Policy Researcher, Institute For Global Environmental Strategies [IGES]</p> <p>Session Chair: <b>Assoc Prof Simon Tay</b> Venue: <b>Auditorium</b> L.O.: <b>Gavin Chua</b></p>
1200 – 1330	<b>Lunch</b>
1330 – 1500	<p><b>Concurrent Sessions</b></p> <p><b>Specialist Panel 1:</b> Living With Natural Hazards Convener: <b>Elisabeth Bui</b> Chair: <b>Elisabeth Bui</b> L.O.: <b>Jason Tee</b> Venue: <b>LT1</b></p> <p>Singapore's Tsunami Early Warning System <b>Wong Chin Ling</b></p> <p>Managing SARS: Singapore's Experience <b>Jeffery Cutter</b></p> <p>GIS In Health Surveillance and Public Health Management—Its Application To SARS <b>Lun K.C.</b></p> <p>Planning For Cyclones <b>Katherine Vanderlaan</b></p> <p>Living With Natural Hazards: The Role of The Media <b>David L. Higgitt</b></p>

1330 – 1500	<p><b>Specialist Panel 2:</b> Labour Migration and Sustainable Development Convener: <b>Noorashikin Ab. Rahman</b> Chair: <b>Shirlena Huang</b> Discussant: <b>Brenda Yeoh</b> L.O.: <b>Kevin Pang</b> Venue: <b>LT2</b></p> <p>Rural To Urban Labour Migration In Vietnam During Doi Moi: A Study of Child Domestic Workers <b>Thuy Dang Bich</b></p> <p>Housing and The Foreign “Other”: Sustaining The Global City Vision At A Compromise? <b>Noor Abdul Rahman</b></p> <p>Transnational Municipal Governance In Singapore <b>Eric C. Thompson</b></p> <p>Disciplining Migrant Labour, Building Malaysia <b>Alice M. Nah</b></p>
1330 – 1500	<p><b>Session 1:</b> City and Sustainable Development -Physical Dimensions 1 Chair: <b>Mohamed Z.O.</b> L.O.: <b>Xu Wan Jing</b> Venue: <b>Board Room</b></p> <p>Rapid Industrialisation and The Urban Metabolism – Case Study of Singapore. <b>Niels Schulz</b></p> <p>Prospects For Achieving Loop-Closure In Three Urban-Industrial Metabolisms In The Western Cape Province, South Africa. <b>Neil Dewar and Barrie Gasson</b></p> <p>Artificial Changes of The Environment In The Eastern Parts of Cologne - A Depositional and Technological Journey From The Devonian To The Present. <b>Neber A. and Classon F.</b></p> <p>Sustainable Resource Use of The Sand Dunes In The Central Coasts of Vietnam: Opportunities and Challenges. <b>Nguyen Khac Anh</b></p> <p>Ecosystem Approaches and Urban Environmental Planning. <b>Marcotullio Peter J</b></p>
1330 – 1500	<p><b>Session 2:</b> City and Sustainable Development - Human Dimensions 1 Chair: <b>Caroline Seah</b> L.O.: <b>Audrey Ngerng</b> Venue: <b>Conference Room B</b></p> <p>Assessing Progress Towards Urban Sustainability – Question of Concepts. <b>Ooi Giok-Ling</b></p> <p>In Search of A Sustainable City: Rebuilding Jakarta Destroyed by Fire. <b>Jerome Tadie</b></p>

	<p><b>Session 2 (Cont'd)</b></p> <p>Human Rights and The Urban Ecology. <b>Gunes Serkan and Yilmaz Gülsen</b></p> <p>Poverty Alleviation and Urbanization <b>Muliaina Tolu</b></p> <p>Migrants and The Socio-Economic Development Of Ho Chi Minh City, Vietnam <b>Le Van Thanh</b></p>
1330 – 1500	<p><b>Session 3:</b> Politics, Policies and Sustainability 1 Chair: <b>Rahil Ismail</b> L.O.: <b>Leah Aw</b> Venue: <b>Conference Room C</b></p> <p>Local Institutions At The Crossroads of Environmental and Natural Resources Governance In Southeast Asia: State-Civil Society Interfaces and Tensions In The Context of Regionalisation. <b>Antonio P. Contreras</b></p> <p>Sustainable Development and Environmental Policy In India. <b>Somayajulu U.V.</b></p> <p>When Sustainable Is Not Sustainable: The Discursive Struggle Between Greenpeace International and The Malaysian Timber Certification Council. <b>Robin A. Lewis</b></p> <p>The impact of the Local Government Code 1991 on road management devolution in the Philippines <b>Emi Kainuma and Koichi Tanaka</b></p>
1500 – 1530	Tea Break
1530 – 1715	<p><b>Concurrent Sessions</b></p> <p><b>Specialist Panel 3:</b> SE Asian Culture and Identities In A Globalising World Convener: <b>Rahil Ismail, Brian J Shaw</b> Chair: <b>Victor Savage</b> L.O.: <b>Leah Aw</b> Venue: <b>LT1</b></p> <p>Historic Port Cities: Issues of Heritage, Politics and Identity <b>Brian J Shaw</b></p> <p>‘Di-waktu petang di Geylang Serai’- Geylang Serai: Maintaining Identity in a Globalised World <b>Rahil Ismail</b></p> <p>The Morphogenesis and Cultural Layers of Southeast Asian Coastal Cities <b>Johannes Widodo</b></p> <p>Being Javanese in a Changing Javanese City <b>Ambar Widiastut</b></p> <p>When was Burma? Where is Burma? What is Burma? Ethnicity in Burmese Nationalism <b>Nancy Hudson-Rodd</b></p>

1530 – 1715	<p><b>Specialist Panel 4:</b>  Post-Tsunami In Southeast Asia  Convener: <b>Carl Grundy-Warr</b>  Chair: <b>Philip Tieh</b>  L.O.: <b>Xu Wan Jing</b>  Venue: <b>LT2</b></p> <p>What A Difference A Border Makes. Missing Storylines of The Tsunami  <b>Carl Grundy-Warr</b></p> <p>Understanding The Tsunami: Visual Imagery In Overlapping Networks of Practice  <b>Lisa Law</b></p> <p>Beyond The Political Economy of A Natural Disaster: Thailand and The 2004 Tsunami  <b>Jonathan Rigg</b></p> <p>The Cultural Politics of Post-Tsunami Aceh  <b>Tim Bunnell</b></p> <p>Re-Mapping the Politics of Aid: The Changing Structures and Networks of Humanitarian Assistance in Post-Tsunami Thailand  <b>May Tan Poh Mui</b></p>
1530 – 1715	<p><b>Session 4:</b>  Remote Sensing and GIS 1  Chair: <b>Kaswan Nathuram</b>  L.O.: <b>Audrey Ngerng</b>  Venue: <b>Conference Room B</b></p> <p>Soil Suitability Mapping For GIS-Based Land Reform Decisions In Rural Cambodia.  <b>Mund Jan-Peter and Van Engelen V.</b></p> <p>Urban Land Use Mapping and Analysis Using High Spatial Resolution Satellite Imageries.  <b>Suthakar Karunakaran and, Elisabeth N. Bui</b></p> <p>Tsunami Impact Assessment Along Nagapattinam, Southeast Coast of India Using Indian Remote Sensing (IRS P6) Digital Data.  <b>Anand P.H.</b></p>
1530 – 1715	<p><b>Session 5:</b>  Nature, Culture and Society 1  Chair: <b>Kwa Bee Hoon</b>  L.O.: <b>Jacqueline Lee</b>  Venue: <b>Conference Room C</b></p> <p>Land Conflicts and Conflict Resolution Through Cadastral Commission, Cambodia.  <b>Sithan Phann</b></p> <p>Relations Between River and Hill Communities In The Nam Khan Valley.  <b>Bernard Moizo and Simmalavong P.</b></p> <p>Natural Resource Management In Thar Desert: A Case Study of Churu District, India  <b>Sheikh M. M.</b></p> <p>How Can We Know What Makes Malaysia Tick? A Dilemma In “Regional Geography”  <b>Doug Johnston</b></p> <p>The Rise, Fall, and Reemergence of Academic Geography in North America  <b>Mike S. DeVivo</b></p>

1530 – 1715	<p><b>Session 6:</b>  Securing Water Supplies  Chair: <b>Yap Kheng Guan</b>  L.O.: <b>Alvin Sim</b>  Venue: <b>Board Room</b></p> <p>Singapore and its water resources  <b>Christina Y.P. Ting</b></p> <p>‘As The Lion Panteth For The Water’: Sustaining Resources Through Governing People and Nature.  <b>Gavin Chua Hearn Yuit</b></p> <p>Best Management Practices For Stormwater and Heat Reduction Using Green Roof Model: The Bangi Experimental Plot.  <b>Shaharuddin Ahmad, Noorrazuan Md. H. and Yaakob M. J.</b></p> <p>Dam Failure and Potential Impact Scenarios In Malaysia – A Precautionary Principle Approach.  <b>Khairulmaini Osman Salleh and Fauza Ab.</b></p> <p>Sediment and Water Transport by The Large Rivers of Myanmar.  <b>Robinson R.A.J, Michael Bird.</b></p>
1730 -1800	Assemble At Foyer For Transportation To Conference Dinner
1900 – 2100	Conference Dinner At National Library, Bras Basah Road

# Programme for Day 2

29 November 2006

## Teachers' Colloquium

0800 – 0900	Registration
0900 – 1030	<p><b>Geography Teachers' Association</b> Keynote Address: <b>Assoc. Prof. John Lidstone</b>, Queensland University of Technology</p> <p><b>Pearson Education</b> Plenary Address: <b>Prof. Ian Douglas</b>, Emeritus Professor, University of Manchester</p> <p>Plenary Address: <b>Mr Anthony Egerton</b>, MD, Lloyd's Asia</p> <p>Session Chair: <b>Prof Jonathan Rigg</b> Venue: <b>Auditorium</b> L.O.: <b>Pushpa</b></p>
1030 – 1100	Tea Break : Sponsored by Innovative Education, New Zealand
1100 – 1230	<p><b>Specialist Panel 5:</b> UN Decade of Education For Sustainable Development Convener: <b>David Higgitt</b> Chair: <b>Ong Shir Nee</b> L.O.: <b>Yeo Li Yong</b> Venue: <b>Conference Room B</b></p> <p>Environmental Education and Education For Sustainable Development (EE/ESD) In The Schools of Vietnam – Status and Action Plan for The Period 2006-2014 <b>Ngo Thi Tuyen</b></p> <p>Examining Some Precursors For Education For Sustainable Development In Singapore <b>David Higgitt</b></p> <p>'Outside In' – Education For Sustainability (EFS) and Students' Daily Experience. Initiatives At The Australian National University <b>Robert Dyball</b></p>
1100 – 1230	<p><b>Session 7:</b> Sustainability and Education 1 Chair: <b>Maggie Wong</b> L.O.: <b>Chee Siew Yan</b> Venue: <b>LT2</b></p> <p>Fieldwork: Views, Values &amp; Perceptions of Fieldwork In Singapore Schools. <b>Edwin Chew</b></p> <p>Environmental Education In Schools and Institute of Higher Learning: Establishing A World Class Environmental Science Programme At Nanyang Girls' High School. <b>Neville Ellis and Christine Lee,</b></p> <p>Seeing The World Through Maps: A Study of Maps In Geographic Education In Singapore. <b>Han Songguang</b></p>

	<p><b>Session 7 (Cont'd)</b> Sufficiency Economy-Based Instruction: A Meaningful Learning Concept For A Small-Sized School Network. <b>Saripa Aree</b></p> <p>Podcast: A New Tool For Assessment In The Making. <b>Kenneth Y T Lim and K S William Yeo</b></p>
1100 – 1230	<p><b>Session 8:</b> Sustainable Management Modelling Chair: <b>Ng Hian Koon</b> L.O.: <b>Tan Hui Yi</b> Venue: <b>Computer Lab</b></p> <p>The Urban Subsurface In Three Dimensions Using GSI3D - Decision Support For A Sustainable Management Based On 3D Geological/Technological Structure Models - A Guideline Towards Best Practice. <b>Neber A., Classon, F. and Howahr, M.</b></p>
1100 – 1230	<p><b>Session 9:</b> Tourism and Sustainable Development 1 Chair: <b>Doracie B. Zoleta-Nantes</b> Discussant: <b>Antonio P Contreras</b> L.O.: <b>Alvin Tan</b> Venue: <b>LT1</b></p> <p>Sustainable Tourism. <b>Doug Farr</b></p> <p>Cultural Tourism As A Tool For Sustaining Local Values: Beypazari Case. <b>Gurel Ucer A., Gurer, N. and Sat, N.A</b></p> <p>A Bird's View On Tourism of Karnataka – India <b>Wodeyar A. K.</b></p>
1100 – 1230	<p><b>Session 10:</b> Sustainability and Education 2 Chair: <b>Rita Yap</b> L.O.: <b>Huang Shijun</b> Venue: <b>Board Room</b></p> <p>Learning Journeys: National Identity and Place-Making In The Singapore Education System. <b>Madeline Chen Zhaoyan</b></p> <p>Integrated Health Promotion In The Learning Process and Development of Guidelines. <b>Sota C., Kumpor, P., Sangsitthisawas, W., Rithmak, P. and Kaowlad, N.</b></p> <p>The Development of A Learning Kit On Solid Waste Management For Primary 4-6 Pupils: A Case Study of Schools In Changwat Songkhla. <b>Paengkaew W., Roongtawanreongsri, S. and Kittitornkool, J.</b></p> <p>Curriculum Development For Land Management and Land Tenure Education Programs In Cambodia. <b>Setha V., Pau, L C and Mund, J-P</b></p> <p>The State of Geographic Education In The Private and Public Elementary Schools In The Philippines. <b>Yany P. Lopez</b></p>
1230 – 1330	Lunch

1330	Participants For Fieldtrips Gather At Foyer
1330 - 1500	<p><b>Concurrent Sessions</b></p> <p><b>Specialist Panel 6:</b> Assessment In Geography Convener: <b>Chang Chew Hung</b> Chair: <b>Lanegrn David</b> L.O.: <b>Chee Siew Yan</b> Venue: <b>Board Room</b></p> <p>Panel Discussion With <b>Chang Chew Hung, Ong Hien Kiat and Ng Hian Koon</b></p>
1330 - 1500	<p><b>Specialist Panel 7:</b> Non-Governmental Organisations and Sustainability Convener: <b>George Jacobs &amp; Howard Shaw</b> <b>Chair: Adeline Wee</b> L.O.: <b>Pang Yu Shan</b> Venue: <b>LT1</b></p> <p>Panel discussants: <b>George Jacobs, Wilson Ang, Louis Ng, N. Sivasothi &amp; Howard Shaw</b></p>
1330 - 1500	<p><b>Session 11:</b> City and Sustainable Development -Human Dimensions 2 Chair: <b>Charles Chan</b> L.O.: <b>Tan Hui Yi</b> Venue: <b>LT2</b></p> <p>Urbanisation Trends and Urban Land Management Examples From Provincial Cambodian Cities. <b>Rattanak N., Mund, J-P and Seang, T. P</b></p> <p>Sustaining City Living: Navigating and Capitalising On Space In Phnom Penh. <b>Sok Leang</b></p> <p>Sustaining City Livelihoods: Phnom Penh's Urban Poor. <b>Ham Samnom</b></p> <p>Urbanization and Sustainability In The Least Developed Southeast Asian and Pacific Countries: Issues and Challenges. <b>Mohanty Manoranjan</b></p> <p>Impact of Urbanization On Soils: A Preliminary Review. <b>Marcotullio Peter J</b></p>
1330 - 1500	<p><b>Session 12:</b> Agriculture and Sustainable Development Chair: <b>Satoshi Yokoyama</b> L.O.: <b>Isaac Phoon</b> Venue: <b>Conference Room B</b></p> <p>Cambodia's Agricultural Sector: Recent Trends and Disparities. <b>Bunthan Ngo and Mund J-P.</b></p>

	<p><b>Session 12 (Cont'd)</b></p> <p>Gender Roles In Farming Practices In Parts of Rice Granary of West Bengal, India. <b>Chandrima Sen</b></p> <p>Crop Diversification For Sustainable Agriculture: A Case Study From The Mahaweli Development Programme of Sri Lanka. <b>Dharmasiri Rk Lal Mervin</b></p> <p>Farm Economies In Hanoi In Transition. <b>Ngo Thi Hai Yen</b></p> <p>Growing Unsustainability of Agriculture in Selected Villages of South Karnataka in India: A Case Study <b>Eswarappa B. and Subash S.</b></p>
1330 - 1500	<p><b>Session 13:</b> Nature, Culture and Society 2 Chair: <b>Khong Kay Lim</b> L.O.: <b>Nagulan</b> Venue: <b>Conference Room C</b></p> <p>Trans-Boundary Conservation Cooperation: A Step Towards Rainforest Sustainability of Southeast Asia Through An Analytical Study of Borneo <b>Kavita Arora</b></p> <p>The Kachins of Northeastern Myanmar: Culture and Environment. <b>Nwe Than-Than</b></p> <p>Overview of Overseas Out – Migration and Its Impacts In Rural Northeast Thailand. <b>Aimimtham Sukanya</b></p> <p>Measuring The Effectiveness of Strategies For City Center Sustainability. <b>Kotval Zenia</b></p> <p>Wild resource-use complex and its recent change in the Vientiane Plain, Lao PDR <b>Kenichi Nonaka and Akiko Ikeguchi</b></p>
1500-1530	Tea Break
1530 - 1700	<p><b>Concurrent Sessions</b></p> <p><b>Specialist Panel 8:</b> Environmental Education In Schools Convener: <b>Ivy Tan Geok Chin</b> Chair: <b>Karl Donert</b> L.O.: <b>Isaac Phoon</b> Venue: <b>Board Room</b></p> <p>Environmental Education At Cedar Primary School <b>Zaki Jalil</b></p> <p>Green Wave and Education <b>Rosalie Capel</b></p> <p>Environmental Education Through Integrated Learning <b>Ow Chin Fong</b></p> <p>Journey In Environmental Education: A Reflection <b>Ong-Boey Wai Ling and Yak-Foo Sheau Yang</b></p>

1530 - 1700	<p><b>Specialist Panel 9:</b> G-Portal and Sustainable Development Convener: <b>Kalyani Chatterjea</b> Chair: <b>Ong Hien Kiat</b> L.O.: <b>Ron Tan</b> Venue: <b>LT1</b></p> <p>Collaborative Fieldwork for Environmental Analysis Using G-Portal <b>Kalyani Chatterjea , Ee-Peng Lim , Chew Hung Chang, Yin-Leng Theng, Dion Hoe-Lian Goh and Jun Zhang</b></p> <p>Understanding User Perceptions On Usefulness and Usability of An Integrated Wiki-G-Portal <b>Yin-Leng Theng, Yuanyuan Li, Ee-Peng Lim, Zhe Wang, Dion Hoe-Lian Goh, Chew-Hung Chang, Kalyani Chatterjea and Jun Zhang</b></p>
1530 - 1700	<p><b>Session 14:</b> City and Sustainable Development -Human Dimensions 3 Chair: <b>Chua Puay Lan</b> L.O.: <b>Huang Shijun</b> Venue: <b>LT2</b></p> <p>Small Cities and Regional Sustainable Development In Iran. <b>Fanni Zohreh</b></p> <p>Town Planning and Planting In Colonial Singapore: Beyond The Raffles Creation Myth (1819-1823). <b>Clement Liew and Wong T-C</b></p> <p>Household Adaptations To Flooding Disasters In Thua Thien Hue Province In Central Viet Nam <b>Doracie B. Zoleta-Nantes</b></p> <p>Urban Space and the Informal Sector in Papua New Guinea: A Case Study of Port Moresby. <b>Georgina Numbasa</b></p>
1530 - 1700	<p><b>Session 15:</b> Nature, Culture and Society 3 Chair: <b>Lim Bee Kee</b> L.O.: <b>Nagulan</b> Venue: <b>Conference Room B</b></p> <p>Sustaining Leisure and Livelihoods Among Urban Youth: A Case Study From Phnom Penh. <b>Yin Sombo and Sok Ra</b></p> <p>Site of Massacre, Sites of Mourning: War Deathscapes In Malaysia. <b>Kevin Blackburn and Wan Meng Hao</b></p> <p>Community Development and Theravada Buddhism: Comparative and Chronological Study of "Development Monks" In Northeast Thailand. <b>Sakurai, Yoshihide</b></p> <p>Sustainable Ambiguities: Urbanization and Periurbanism in Southeast Asia <b>Michael Leaf</b></p>

1530 - 1700	<p><b>Session 16:</b> Health and Development Issues Chair: <b>David Higgitt</b> L.O.: <b>Pang Yu Shan</b> Venue: <b>Conference Room C</b></p> <p>The Internal Evaluation of Survey and Situation Assessment For Health Promotion In Public Health Education Institute, Thailand. <b>Sota C., Panthajarunithi, N.Tonee, S. Pamsila, V. Ratorial, S. Rodjakpai, Y. Yuttithum, M</b></p> <p>Variation and Distribution of Mercury In The Tissues of Aquatic Organisms Catching From Songkhla Lake <b>Sukapan Sutarat, Sompongchaiyakul, P. and Khokiattiwong, S.</b></p> <p>Travel Behavior, Physical Activity, and The Urban Built Environment: A Multi-Scale Geographical Analysis. <b>Vojnovic Igor</b></p>
-------------	---

# Programme for Day 3

30 November 2006

0900 - 1030	<p>Plenary Address <b>Mr Roy Adair</b>, CEO, Senoko Power Limited, Singapore</p> <p>Plenary Address <b>Dr Geh Min</b>, Nominated Member of Parliament and President of Nature Society (Singapore)</p> <p>Plenary Address <b>Mr Karl Donert</b>, Coordinator Herodot Thematic Network For Geography In Higher Education In Europe and National Teaching Fellow, Liverpool Hope University</p> <p>Session Chair: <b>Prof. Avijit Gupta</b> Venue: <b>Auditorium</b> L.O.: <b>Clara Lim</b></p>
1030 - 1100	Tea Reception
1100 - 1230	Concurrent Sessions
	<p><b>Specialist Panel 10:</b> Mekong Geographies of Natural Resource Governance and Regulation Part 1: Natural Resource Governance Convener: <b>Philip Hirsch</b> Chair: <b>Brian Shaw</b> L.O.: <b>Joan Wong</b> Venue: <b>LT1</b></p> <p>Mekong Geographies of Natural Resource Governance and Regulation <b>Philip Hirsch</b></p> <p>Governance of Coastal Fisheries Resources In Vietnam: Local Institutions and Global Participation <b>Paula Brown</b></p> <p>Community Knowledge Resources, Rights and Rural Livelihoods In Thailand: Exploring Local Expectations, Spatial Politicisations and Regulatory Change <b>Daniel Robinson</b></p> <p>Pipedreams: Narratives On Water and Development In North-Eastern Thailand <b>Natalia Scurrah</b></p>

1100 - 1230	<p><b>Specialist Panel 11:</b> Bukit Timah Nature Reserve: Sustainability and Conservation Issues Convener: <b>Kalyani Chatterjea</b> Chair: <b>Daphne Wong</b> L.O.: <b>Alvin Sim</b> Venue: <b>LT2</b></p> <p>Urban Forest Sustainability, Threat and Public Response: The Case of Bukit Timah Nature Reserve <b>Kalyani Chatterjea</b></p> <p>Forest Trail Monitoring and Management At Bukit Timah Nature Reserve Using Mobile Technology and GIS <b>Kalyani Chatterjea, Ong Chee Fatt</b></p> <p>Managing Bukit Timah Nature Reserve - A Sustainable Way <b>Sunia Teo</b></p> <p>Partnerships In Conservation: Bukit Timah Nature Reserve <b>Karen Teo and Sharon Chan</b></p>
1100 - 1230	<p><b>Specialist Panel 12:</b> GIS For Sustainable Development Convener: <b>Liu Yan and Lu Xi-Xi</b> Chair: <b>Doug Johnston</b> L.O.: <b>Clara Lim</b> Venue: <b>Conference Room B</b></p> <p>Establishing A Sustainable Landscape Framework In A Rapid Urbanizing Mountain Area. A Case Study of Chongqing, China <b>Jingnan Huang, and X.X. Lu</b></p> <p>GIS Analysis of River Water Quality Databases For Sustainable Development: Case Studies from Eastern England and Japan <b>Oguchi, T., Jarvie, H.P., Lin, Z., Zaiki, M. and Neal, C.</b></p> <p>Application Challenges In Geographic Information Science: Implications For Emergency Management In Southeast Asia <b>Wang Yi-Chen and Feng Chen-Chieh</b></p> <p>GIS Education At Geographical Departments of Japanese Universities <b>Sasaki, M., Oguchi, T., Sadahiro, Y. and Okabe, A.</b></p>
1100 - 1230	<p><b>Session 17 :</b> Challenges of Sustainable Development Chair: <b>Anand Pagadala Hariram</b> L.O.: <b>Ng Eu khim</b> Venue: <b>Conference Room C</b></p> <p>God of Land and Water and Messianism Among The Pwo Karens, Thailand. <b>Bernard Moizo</b></p> <p>Land Transformation and Urbanization: A Case Study of Bangalore, Karnataka of India <b>Narayanan Priya</b></p>

	<p><b>Session 17 (Cont'd)</b></p> <p>Forest Policy and Swidden Agriculture In Laos. <b>Yokoyama Satoshi, Tanaka Koji (Japan), Phalakhone Khame.</b></p> <p>Sustainable Development In Terms of Environmental Enhancement Contextual Paradigm Shift In Making A Living. <b>Kaswan Nathuram</b></p> <p>Urbanization and Energy Transitions: How Time- and Space-Related Effects Impact Their Linkages In Rapidly Developing Economies. <b>Marcotullio Peter J and Schulz, Niels B</b></p>
1230-1330	Lunch
1330-1500	<p><b>Concurrent Sessions</b></p> <p><b>Specialist Panel 13:</b> Land Use Planning and Sustainability Convener: <b>Wong Tai-Chee</b> Chair: <b>Tim Bunnell</b> L.O.: <b>Joan Wong</b> Venue: <b>LT1</b></p> <p>Singapore's Urban Transport: Sustainability by Design Or Necessity? <b>Paul A. Barter</b> Singapore's Natural Environment, Past, Present and Future: A Construct of National Identity, Heritage and Land Use Imperatives <b>Geh Min</b></p> <p>Nature and Environmental Sustainability <b>L.M. Chou</b></p> <p>Sustainable Recreational Space: The Integrated Resorts In Singapore <b>Wong Tai-Chee</b></p>
1330-1500	<p><b>Specialist Panel 14:</b> Mekong Geographies of Natural Resource Governance and Regulation Part 2: Territoriality and Development Convener: <b>Philip Hirsch</b> Chair: <b>Robin Lewis</b> L.O.: <b>Ng Eu khim</b> Venue: <b>LT2</b></p> <p>Nation-State Making, Territorialization and Development of Thailand: Critical Views on Forest, Land and Water Governance <b>Chusak Witayapak</b></p> <p>Territoriality of The Tonle Sap Lake and Implications For Resource Management <b>Mak Sitthirith</b></p> <p>Whose CBNRM? A Case Study of Fisheries Co-Management In Southern Laos <b>Nattaya Tubtim</b></p>

1330-1500	<p><b>Session 18:</b> Remote Sensing and GIS 2 Chair: <b>Lu Xi Xi</b> L.O.: <b>Wong Wai See</b> Venue: <b>Conference Room B</b></p> <p>Mapping The Demographic Profile and Spatial Diversity of Baby Boomers In Singapore Using GIS. <b>Yan Liu</b></p> <p>Geo-Referenced Balloon Aerial Photo Technique: A Low Cost High Resolution Option For Developing Countries. <b>Seang Teang Peng and Mund J-P.</b></p> <p>Analysis of Compactness/ Sprawl Ratio In Sydney and Mashhad Metropolitan Areas: A Comparative Study. <b>Rahnama M.R.</b></p>
1330-1500	<p><b>Session 19:</b> Tourism and Sustainable Development 2 Chair: <b>Wong Shuang Yann</b> L.O.: <b>Alvin Sim</b> Venue: <b>Conference Room C</b></p> <p>Sustainable Tourism. <b>Doug Farr</b></p> <p>On The Concept of Sustainable Tourism and The Poverty Reduction Strategy. <b>Ito Akio</b></p> <p>Sustainable Tourism In Plantation Areas In Malaysia: Case of FELDA Land Schemes. <b>Fatimah H., Nurwati, B., Mohamed Z. O. and Main, R.</b></p> <p>Sustainable Ecotourism: Southeastern Anatolia Region and Project In Turkey As A Case Study. <b>Acma Bulent</b></p>
1500-1530	<p>Sustainability and the future of Southeast Asia Closing Keynote Address <b>Prof. Jonathan Rigg</b></p> <p>Closing Remarks <b>Asst. Prof. Chang Chew Hung,</b> Secretary SEAGA</p> <p>Venue: <b>Auditorium</b></p>
1530 -1600	Tea Break

End of Programme